



3pol 4pol 5pol
4h 4h 4h

3pol 4pol 5pol
6h 3h 5h

3pol 4pol 5pol
9h 6h 6h

3pol 4pol 5pol
7h 7h 7h

3pol 4pol 5pol
19h 10h 10h

3pol 4pol 5pol
2h 2h 2h

极数
3
2P+E

4
3P+E

5
3P+N+E

www.cnmcbb.com

第二代器具插座 Second Implement Socket



LK-513-4 LK-523-4

| | | |
|--|------|-------------|
| earth contact position | 4h | |
| rated current(A) | 16 | 32 |
| | pole | 3 |
| dimension(mm) | a | 133 |
| | b | 81 |
| cable nominal cross-section area(mm ²) | | 1-2.5 2.5-6 |

电 流 Current(A): 16A. 32A
电 压 Voltage(V): 110-130V~2P+E
防护等级 Protection degree: IP44

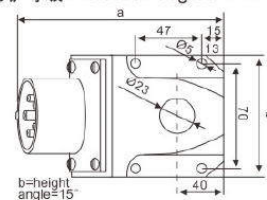

LK-513 LK-523

| | | |
|--|------|-------------|
| earth contact position | 6h | |
| rated current(A) | 16 | 32 |
| | pole | 3 |
| dimension(mm) | a | 133 |
| | b | 81 |
| cable nominal cross-section area(mm ²) | | 1-2.5 2.5-6 |

电 流 Current(A): 16A. 32A
电 压 Voltage(V): 220-240V~2P+E
防护等级 Protection degree: IP44

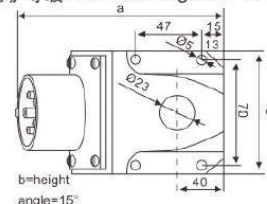

电 流 Current(A): 16A. 32A
电 压 Voltage(V): 380V-415V~3P+E
防护等级 Protection degree: IP44

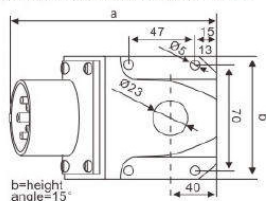

| | | |
|--|------|-------------|
| earth contact position | 6h | |
| rated current(A) | 16 | 32 |
| | pole | 4 |
| dimension(mm) | a | 133 |
| | b | 81 |
| cable nominal cross-section area(mm ²) | | 1-2.5 2.5-6 |



LK-514 LK-524

电 流 Current(A): 16A. 32A
电 压 Voltage(V): 220-380V~3P+N+E
240-415V~3P+N+E
防护等级 Protection degree: IP44

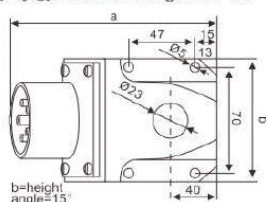

| | | |
|--|------|-------------|
| earth contact position | 6h | |
| rated current(A) | 16 | 32 |
| | pole | 5 |
| dimension(mm) | a | 133 |
| | b | 81 |
| cable nominal cross-section area(mm ²) | | 1-2.5 2.5-6 |



LK-515 LK-525

电 流 Current(A): 63A. 125A
电 压 Voltage(V): 110-130V~2P+E
防护等级 Protection degree: IP67

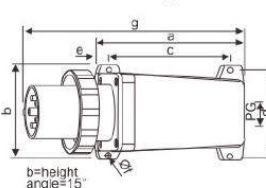

| | | |
|------------------------|--|-----|
| earth contact position | 4h | |
| rated current(A) | 63 | 125 |
| | pole | 3 |
| dimension(mm) | a | 223 |
| | b | 145 |
| | c | 185 |
| | d | 133 |
| | e | 17 |
| | f | 8 |
| | g | 317 |
| | h | 140 |
| | PG | 36 |
| | cable nominal cross-section area(mm ²) | |



LK-5332-4 LK-5432-4

电 流 Current(A): 63A. 125A
电 压 Voltage(V): 220-240V~2P+E
防护等级 Protection degree: IP67

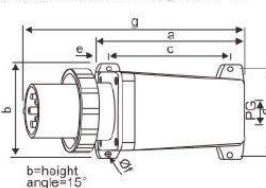

| | | |
|------------------------|--|-----|
| earth contact position | 6h | |
| rated current(A) | 63 | 125 |
| | pole | 3 |
| dimension(mm) | a | 223 |
| | b | 145 |
| | c | 185 |
| | d | 133 |
| | e | 17 |
| | f | 8 |
| | g | 317 |
| | h | 140 |
| | PG | 36 |
| | cable nominal cross-section area(mm ²) | |



LK-5332 LK-5432



3pol 4pol 5pol
4h 4h 4h



3pol 4pol 5pol
6h 3h 5h



3pol 4pol 5pol
9h 6h 6h



3pol 4pol 5pol
7h 7h 7h



3pol 4pol 5pol
19h 10h 10h



3pol 4pol 5pol
2h 2h 2h



极数
3
2P+E



4
3P+E



5
3P+N+E

电 流 Current(A): 63A. 125A

电 压 Voltage(V): 380-415V~3P+E

防护等级 Protection degree: IP67

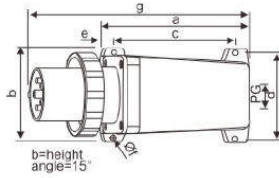

| | | | |
|--|--------|-------|-----|
| earth contact position | 6h | | |
| rated current(A) | 63 | 125 | |
| | pole 4 | | |
| dimension(mm) | a | 193 | 223 |
| | b | 123 | 145 |
| | c | 153 | 185 |
| | d | 111 | 133 |
| | e | 21 | 17 |
| | f | 6 | 8 |
| | g | 288 | 317 |
| | h | 127 | 140 |
| | PG | 29 | 36 |
| cable nominal cross-section area(mm ²) | 6-16 | 16-50 | |



LK-5342 LK-5442

电 流 Current(A): 63A. 125A

电 压 Voltage(V): 220-380V~ 240-415V~ 3P+N+E

防护等级 Protection degree: IP67

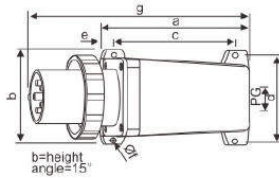

| | | | |
|--|--------|-------|-----|
| earth contact position | 6h | | |
| rated current(A) | 63 | 125 | |
| | pole 5 | | |
| dimension(mm) | a | 193 | 223 |
| | b | 123 | 145 |
| | c | 153 | 185 |
| | d | 111 | 133 |
| | e | 21 | 17 |
| | f | 6 | 8 |
| | g | 288 | 317 |
| | h | 127 | 140 |
| | PG | 29 | 36 |
| cable nominal cross-section area(mm ²) | 6-16 | 16-50 | |



LK-5352 LK-5452

第二代暗装器具插座 Second Implement Socket



LK-613-4 LK-623-4

| | | |
|--|--------|-------|
| earth contact position | 4h | |
| rated current(A) | 16 | 32 |
| | pole 3 | |
| dimension(mm) | a | 75 |
| | b | 75 |
| | c | 61 |
| | d | 61 |
| | e | 25 |
| | f | 41 |
| | g | 5 |
| | h | 43 |
| cable nominal cross-section area(mm ²) | 1-2.5 | 2.5-6 |

电 流 Current(A): 16A. 32A

电 压 Voltage(V): 110-130V~2P+E

防护等级 Protection degree: IP44

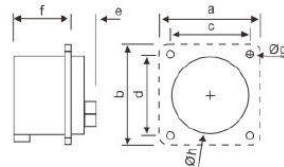

LK-613 LK-623

| | | |
|--|--------|-------|
| earth contact position | 6h | |
| rated current(A) | 16 | 32 |
| | pole 3 | |
| dimension(mm) | a | 75 |
| | b | 75 |
| | c | 61 |
| | d | 61 |
| | e | 25 |
| | f | 41 |
| | g | 5 |
| | h | 43 |
| cable nominal cross-section area(mm ²) | 1-2.5 | 2.5-6 |

电 流 Current(A): 16A. 32A

电 压 Voltage(V): 220-240V~2P+E

防护等级 Protection degree: IP44

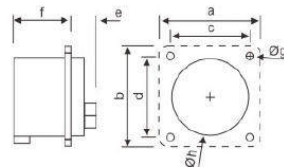

LK-614 LK-624

| | | |
|--|--------|-------|
| earth contact position | 6h | |
| rated current(A) | 16 | 32 |
| | pole 4 | |
| dimension(mm) | a | 75 |
| | b | 75 |
| | c | 61 |
| | d | 61 |
| | e | 25 |
| | f | 41 |
| | g | 5 |
| | h | 43 |
| cable nominal cross-section area(mm ²) | 1-2.5 | 2.5-6 |

电 流 Current(A): 16A. 32A

电 压 Voltage(V): 380-415V~3P+E

防护等级 Protection degree: IP44

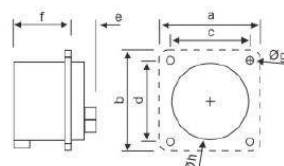

LK-615 LK-625

| | | |
|--|--------|-------|
| earth contact position | 6h | |
| rated current(A) | 16 | 32 |
| | pole 5 | |
| dimension(mm) | a | 75 |
| | b | 75 |
| | c | 61 |
| | d | 61 |
| | e | 26 |
| | f | 42 |
| | g | 5 |
| | h | 55 |
| cable nominal cross-section area(mm ²) | 1-2.5 | 2.5-6 |

电 流 Current(A): 16A. 32A

电 压 Voltage(V): 220-380V~ 240-415V~ 3P+N+E

防护等级 Protection degree: IP44

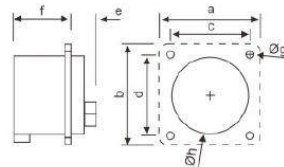

LK-6132-4 LK-6232-4

| | | |
|--|--------|-------|
| earth contact position | 4h | |
| rated current(A) | 16 | 32 |
| | pole 3 | |
| dimension(mm) | a | 75 |
| | b | 61 |
| | d | 64 |
| | e | 74 |
| | f | 40 |
| | g | 5.5 |
| cable nominal cross-section area(mm ²) | 1-2.5 | 2.5-6 |

电 流 Current(A): 16A. 32A

电 压 Voltage(V): 110-130V~2P+E

防护等级 Protection degree: IP67

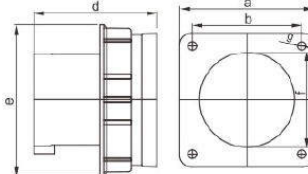

LK-6132 LK-6232

| | | |
|--|--------|-------|
| earth contact position | 6h | |
| rated current(A) | 16 | 32 |
| | pole 3 | |
| dimension(mm) | a | 75 |
| | b | 61 |
| | d | 64 |
| | e | 74 |
| | f | 40 |
| | g | 5.5 |
| cable nominal cross-section area(mm ²) | 1-2.5 | 2.5-6 |

电 流 Current(A): 16A. 32A

电 压 Voltage(V): 220-240V~2P+E

防护等级 Protection degree: IP67

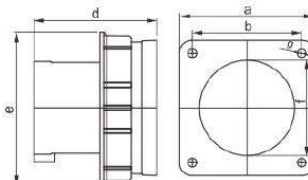



3pol 4pol 5pol
4h 4h 4h

3pol 4pol 5pol
6h 3h 5h

3pol 4pol 5pol
6h 6h 6h

3pol 4pol 5pol
7h 7h 7h

3pol 4pol 5pol
15h 10h 10h

3pol 4pol 5pol
2h 2h 2h

电 流 Current(A): 16A, 32A
电 压 Voltage(V): 380-415V~3P+E
防护等级 Protection degree: IP67

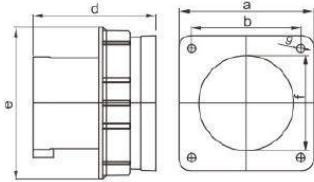

| | | |
|--|--------|-------|
| earth contact position | 6h | |
| rated current(A) | 16 | 32 |
| | pole 4 | |
| dimension(mm) | a | 75 |
| | b | 61 |
| | d | 65 |
| | e | 83 |
| | f | 48 |
| | g | 5.5 |
| cable nominal cross-section area(mm ²) | 1-2.5 | 2.5-6 |



LK-6142 LK-6242

电 流 Current(A): 16A, 32A
电 压 Voltage(V): 220-380V~
240-415V~ 3P+N+E
防护等级 Protection degree: IP67

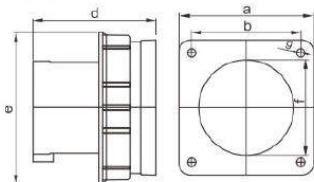

| | | |
|--|--------|-------|
| earth contact position | 6h | |
| rated current(A) | 16 | 32 |
| | pole 5 | |
| dimension(mm) | a | 75 |
| | b | 61 |
| | d | 65 |
| | e | 90 |
| | f | 53 |
| | g | 5.5 |
| cable nominal cross-section area(mm ²) | 1-2.5 | 2.5-6 |



LK-6152 LK-6252

电 流 Current(A): 63A, 125A
电 压 Voltage(V): 110-130V~2P+E
防护等级 Protection degree: IP67

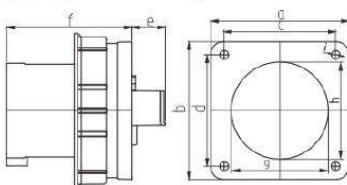

| | | |
|--|--------|-------|
| earth contact position | 4h | |
| rated current(A) | 63 | 125 |
| | pole 3 | |
| dimension(mm) | a | 100 |
| | b | 100 |
| | c | 80 |
| | d | 80 |
| | e | 13 |
| | f | 99 |
| | g | 73 |
| | h | 73 |
| | i | 6 |
| cable nominal cross-section area(mm ²) | 6-16 | 16-50 |



LK-6332-4 LK-6432-4

电 流 Current(A): 63A, 125A
电 压 Voltage(V): 220-240V~2P+E
防护等级 Protection degree: IP67

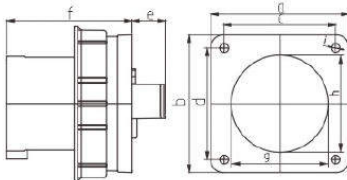

| | | |
|--|--------|-------|
| earth contact position | 6h | |
| rated current(A) | 63 | 125 |
| | pole 3 | |
| dimension(mm) | a | 100 |
| | b | 100 |
| | c | 80 |
| | d | 80 |
| | e | 13 |
| | f | 99 |
| | g | 73 |
| | h | 73 |
| | i | 6 |
| cable nominal cross-section area(mm ²) | 6-16 | 16-50 |



LK-6332 LK-6432

电 流 Current(A): 63A, 125A
电 压 Voltage(V): 380-415V~3P+E
防护等级 Protection degree: IP67

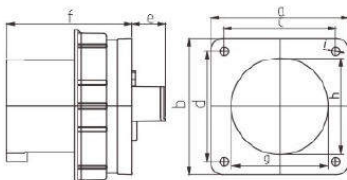

| | | |
|--|--------|-------|
| earth contact position | 6h | |
| rated current(A) | 63 | 125 |
| | pole 4 | |
| dimension(mm) | a | 100 |
| | b | 100 |
| | c | 80 |
| | d | 80 |
| | e | 13 |
| | f | 99 |
| | g | 73 |
| | h | 73 |
| | i | 6 |
| cable nominal cross-section area(mm ²) | 6-16 | 16-50 |



LK-6342 LK-6442

电 流 Current(A): 63A, 125A
电 压 Voltage(V): 220-380V~
240-415V~ 3P+N+E
防护等级 Protection degree: IP67

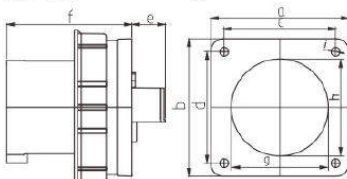

| | | |
|--|--------|-------|
| earth contact position | 6h | |
| rated current(A) | 63 | 125 |
| | pole 5 | |
| dimension(mm) | a | 100 |
| | b | 100 |
| | c | 80 |
| | d | 80 |
| | e | 13 |
| | f | 99 |
| | g | 73 |
| | h | 73 |
| | i | 6 |
| cable nominal cross-section area(mm ²) | 6-16 | 16-50 |



LK-6352 LK-6452