



3pol 4pol 5pol
4h 4h 4h

3pol 4pol 5pol
6h 3h 5h

3pol 4pol 5pol
9h 6h 9h

3pol 4pol 5pol
7h 7h 7h

3pol 4pol 5pol
15h 10h 10h

3pol 4pol 5pol
2h 2h 2h

极数
3
2P+E

4
3P+E

5
3P+N+E

www.cnmcbb.com

第二代工业用暗装斜座 Second Hide Inclined Socket



LK-413-4 LK-423-4

earth contact position	4h	
rated current(A)	16	32
	pole 3	
dimension(mm)	a	85
	b	85
	c	70
	d	70
	e	34
	f	60
	g	51
	h	56
	i	5.5
cable nominal cross-section area(mm ²)	1-2.5	2.5-6

电 流 Current(A): 16A. 32A
电 压 Voltage(V): 110-130V~2P+E
防护等级 Protection degree: IP44

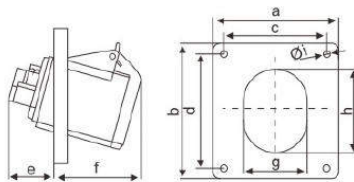

LK-413 LK-423

earth contact position	6h	
rated current(A)	16	32
	pole 3	
dimension(mm)	a	85
	b	85
	c	70
	d	70
	e	34
	f	60
	g	51
	h	56
	i	5.5
cable nominal cross-section area(mm ²)	1-2.5	2.5-6

电 流 Current(A): 16A. 32A
电 压 Voltage(V): 220-240V~2P+E
防护等级 Protection degree: IP44

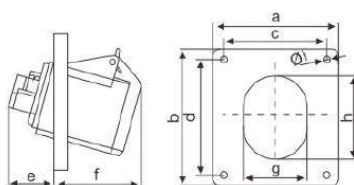

电 流 Current(A): 16A. 32A
电 压 Voltage(V): 380-415V~3P+E
防护等级 Protection degree: IP44

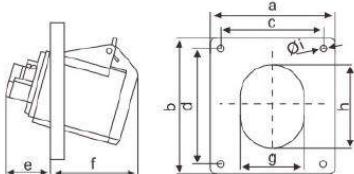

earth contact position	6h	
rated current(A)	16	32
	pole 4	
dimension(mm)	a	85
	b	85
	c	70
	d	70
	e	34
	f	58
	g	62
	h	56
	i	5.5
cable nominal cross-section area(mm ²)	1-2.5	2.5-6



LK-414 LK-424

电 流 Current(A): 16A. 32A
电 压 Voltage(V): 220-380V~240-415V~3P+N+E
防护等级 Protection degree: IP44

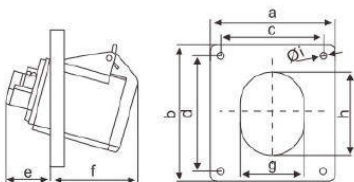

earth contact position	6h	
rated current(A)	16	32
	pole 5	
dimension(mm)	a	85
	b	85
	c	70
	d	70
	e	34
	f	52
	g	64
	h	68
	i	5.5
cable nominal cross-section area(mm ²)	1-2.5	2.5-6



LK-415 LK-425

电 流 Current(A): 16A. 32A
电 压 Voltage(V): 110-130V~2P+E
防护等级 Protection degree: IP67

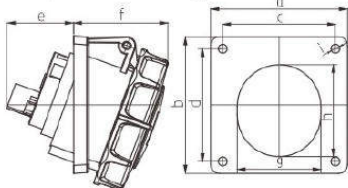

earth contact position	4h	
rated current(A)	16	32
	pole 3	
dimension(mm)	a	85
	b	85
	c	70
	d	70
	e	33
	f	60
	g	51
	h	56
	i	5.5
cable nominal cross-section area(mm ²)	1-2.5	2.5-6



LK-4132-4 LK-4232-4

电 流 Current(A): 16A. 32A
电 压 Voltage(V): 220-240V~2P+E
防护等级 Protection degree: IP67

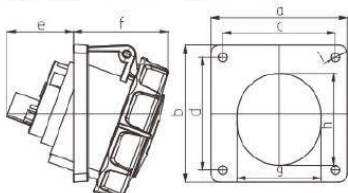

earth contact position	6h	
rated current(A)	16	32
	pole 3	
dimension(mm)	a	85
	b	85
	c	70
	d	70
	e	33
	f	60
	g	51
	h	56
	i	5.5
cable nominal cross-section area(mm ²)	1-2.5	2.5-6



LK-4132 LK-4232

工业用插头、插座、耦合器（连接器）及接插装置

Industrial Power Plug, Socket, Coupler (Connector)

www.cnmcbb.com

电 流 Current(A): 16A. 32A
电 压 Voltage(V): 380-415V~3P+E
防护等级 Protection degree: IP67

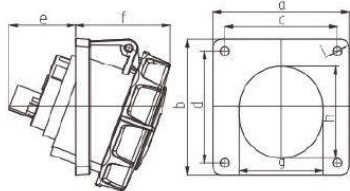

earth contact position	6h	
rated current(A)	16	32
	pole 4	
dimension(mm)	a	85
	b	85
	c	70
	d	70
	e	33
	f	60
	g	56
	h	65
	i	5.5
cable nominal cross-section area(mm ²)	1-2.5	2.5-6



LK-4142 LK-4242

电 流 Current(A): 16A. 32A
电 压 Voltage(V): 220-380V~240-415V~3P+N+E
防护等级 Protection degree: IP67

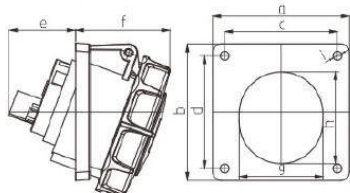

earth contact position	6h	
rated current(A)	16	32
	pole 5	
dimension(mm)	a	85
	b	85
	c	70
	d	70
	e	33
	f	52
	g	64
	h	68
	i	5.5
cable nominal cross-section area(mm ²)	1-2.5	2.5-6



LK-4152 LK-4252



LK-4332-4 LK-4432-4

earth contact position	4h	
rated current(A)	63	125
	pole 3	
dimension(mm)	a	101
	b	113
	c	80
	d	89
	e	64
	f	83
	g	79
	h	92
	i	7
cable nominal cross-section area(mm ²)	6-25	16-50

电 流 Current(A): 63A. 125A
电 压 Voltage(V): 110-130V~2P+E
防护等级 Protection degree: IP67

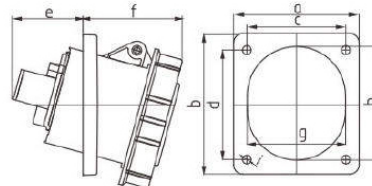

LK-4332 LK-4432

earth contact position	6h	
rated current(A)	63	125
	pole 3	
dimension(mm)	a	101
	b	113
	c	80
	d	89
	e	64
	f	83
	g	79
	h	92
	i	7
cable nominal cross-section area(mm ²)	6-25	16-50

电 流 Current(A): 63A. 125A
电 压 Voltage(V): 220-240V~2P+E
防护等级 Protection degree: IP67

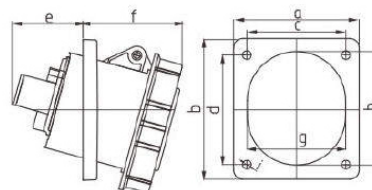

LK-4342 LK-4442

earth contact position	6h	
rated current(A)	63	125
	pole 4	
dimension(mm)	a	101
	b	113
	c	80
	d	89
	e	64
	f	83
	g	79
	h	92
	i	7
cable nominal cross-section area(mm ²)	6-25	16-50

电 流 Current(A): 63A. 125A
电 压 Voltage(V): 380-415V~3P+E
防护等级 Protection degree: IP67

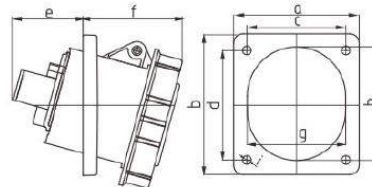

LK-4352 LK-4452

earth contact position	6h	
rated current(A)	63	125
	pole 5	
dimension(mm)	a	101
	b	113
	c	80
	d	89
	e	64
	f	83
	g	79
	h	92
	i	7
cable nominal cross-section area(mm ²)	6-25	16-50

电 流 Current(A): 63A. 125A
电 压 Voltage(V): 220-380V~240-415V~3P+N+E
防护等级 Protection degree: IP67

