



3pol 4pol 5pol
4h 4h 4h

3pol 4pol 5pol
6h 3h 5h

3pol 4pol 5pol
5h 6h 6h

3pol 4pol 5pol
7h 7h 7h

3pol 4pol 5pol
15h 10h 10h

3pol 4pol 5pol
2h 2h 2h

极数

3
2P+E

4
3P+E

5
3P+N+E

www.cnmcbb.com

第二代工业用暗装插座 Second Hide Direct Socket



LK-313-4 LK-323-4

earth contact position	4h		
rated current(A)	16	32	
	pole	3	
dimension(mm)	axb	75	75
	cx-d	61	61
	e	22	24
	f	60	70
	g	5.5	5.5
	h	46	61
	i	87	95
cable nominal cross-section area(mm ²)	1-2.5	2.5-6	

电 流 Current(A): 16A. 32A

电 压 Voltage(V): 110-130V~2P+E

防护等级 Protection degree: IP44

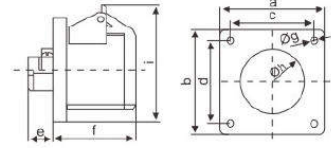

LK-313 LK-323

earth contact position	6h		
rated current(A)	16	32	
	pole	3	
dimension(mm)	axb	75	75
	cx-d	61	61
	e	22	24
	f	60	70
	g	5.5	5.5
	h	43	54
	i	87	95
cable nominal cross-section area(mm ²)	1-2.5	2.5-6	

电 流 Current(A): 16A. 32A

电 压 Voltage(V): 220-240V~2P+E

防护等级 Protection degree: IP44

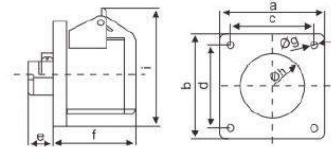

电 流 Current(A): 16A. 32A

电 压 Voltage(V): 380-415V~3P+E

防护等级 Protection degree: IP44

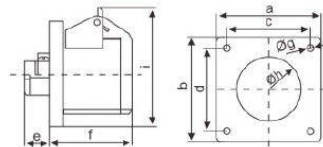

earth contact position	6h		
rated current(A)	16	32	
	pole	4	
dimension(mm)	axb	75	75
	cx-d	61	61
	e	17	24
	f	59	69
	g	5.5	5.5
	h	48	55
	i	88	95
cable nominal cross-section area(mm ²)	1-2.5	2.5-6	



LK-314 LK-324

电 流 Current(A): 16A. 32A

电 压 Voltage(V): 220-380V~240-415V~3P+N+E

防护等级 Protection degree: IP44

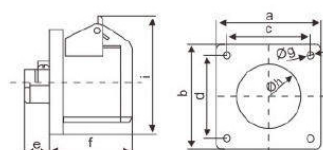

earth contact position	6h		
rated current(A)	16	32	
	pole	5	
dimension(mm)	axb	75	75
	cx-d	61	61
	e	17	22
	f	59	71
	g	5.5	5.5
	h	53	60
	i	92	100
cable nominal cross-section area(mm ²)	1-2.5	2.5-6	



LK-315 LK-325

电 流 Current(A): 16A. 32A

电 压 Voltage(V): 110-130V~2P+E

防护等级 Protection degree: IP67

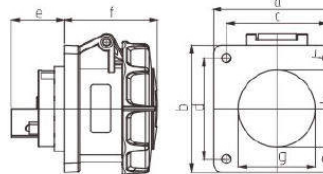

earth contact position	4h		
rated current(A)	16	32	
	pole	3	
dimension(mm)	a	75	75
	b	75	75
	e	61	61
	d	61	61
	e	18	24
	f	63	70
	g	43	54
h	43	54	
i	5	5	
cable nominal cross-section area(mm ²)	1-2.5	2.5-6	



LK-3132-4 LK-3232-4

电 流 Current(A): 16A. 32A

电 压 Voltage(V): 220-240V~2P+E

防护等级 Protection degree: IP67

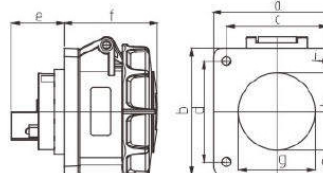

earth contact position	6h		
rated current(A)	16	32	
	pole	3	
dimension(mm)	a	75	75
	b	75	75
	e	61	61
	d	61	61
	e	18	24
	f	63	70
	g	43	54
h	43	54	
i	5	5	
cable nominal cross-section area(mm ²)	1-2.5	2.5-6	



LK-3132 LK-3232

工业用插头、插座、耦合器（连接器）及接插装置

Industrial Power Plug, Socket, Coupler (Connector)

www.cnmcbb.com

电 流 Current(A): 16A, 32A
电 压 Voltage(V): 380-415V~3P+E
防护等级 Protection degree: IP67

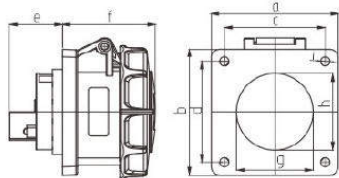

earth contact position	6h		
rated current(A)	16	32	
	pole 4		
dimension(mm)	a	75	75
	b	75	75
	e	61	61
	d	61	61
	f	18	24
	e	63	73
	g	48	55
	h	48	55
	i	5	5
cable nominal cross-section area(mm ²)	1-2.5	2.5-6	



LK-3142 LK-3242

电 流 Current(A): 16A, 32A
电 压 Voltage(V): 220-380V~ 3P+N+E
240-415V~
防护等级 Protection degree: IP67

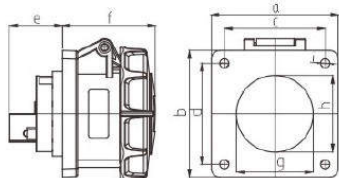

earth contact position	6h		
rated current(A)	16	32	
	pole 5		
dimension(mm)	a	75	75
	b	75	75
	c	61	61
	d	61	61
	e	18	24
	f	63	76
	g	53	60
	h	53	60
	i	5	5
cable nominal cross-section area(mm ²)	1-2.5	2.5-6	



LK-3152 LK-3252



LK-3332-4 LK-3432-4

earth contact position	4h		
rated current(A)	63	125	
	pole 3		
dimension(mm)	a	100	120
	b	100	120
	c	80	101
	d	80	101
	e	35	44
	f	96	106
	g	73	84
	h	73	84
	i	7	7
cable nominal cross-section area(mm ²)	6-16	16-50	

电 流 Current(A): 63A, 125A
电 压 Voltage(V): 110-130V~2P+E
防护等级 Protection degree: IP67

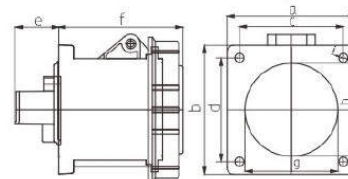

LK-3332 LK-3432

earth contact position	6h		
rated current(A)	63	125	
	pole 3		
dimension(mm)	a	100	120
	b	100	120
	c	80	101
	d	80	101
	e	35	44
	f	96	106
	g	73	84
	h	73	84
	i	7	7
cable nominal cross-section area(mm ²)	6-16	16-50	

电 流 Current(A): 63A, 125A
电 压 Voltage(V): 220-250V~2P+E
防护等级 Protection degree: IP67

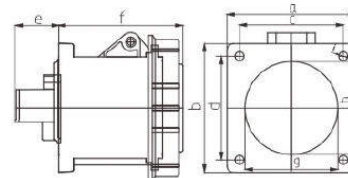

LK-3342 LK-3442

earth contact position	6h		
rated current(A)	63	125	
	pole 4		
dimension(mm)	a	100	120
	b	100	120
	c	80	101
	d	80	101
	e	35	44
	f	96	106
	g	73	84
	h	73	84
	i	7	7
cable nominal cross-section area(mm ²)	6-16	16-50	

电 流 Current(A): 63A, 125A
电 压 Voltage(V): 380-415V~3P+E
防护等级 Protection degree: IP67

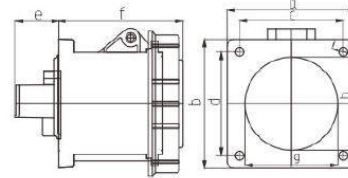

LK-3352 LK-3452

earth contact position	6h		
rated current(A)	63	125	
	pole 5		
dimension(mm)	a	100	120
	b	100	120
	c	80	101
	d	80	101
	e	35	44
	f	96	106
	g	73	84
	h	73	84
	i	7	7
cable nominal cross-section area(mm ²)	6-16	16-50	

电 流 Current(A): 63A, 125A
电 压 Voltage(V): 220-380V~ 3P+N+E
240-415V~
防护等级 Protection degree: IP67

